

WHY IS THIS PROJECT BEING UNDERTAKEN?

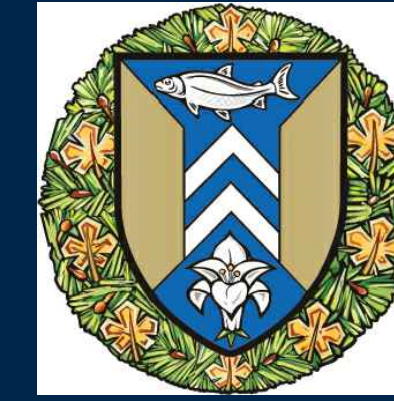

City of
Sault Ste. Marie

- This study was initiated to investigate alternatives to improve the efficiency of the Northern Avenue corridor.
 - The opportunity for Northern Avenue to undergo a possible lane reassignment and/or elimination as well as a possible extension to Black Road was presented in the City of Sault Ste. Marie's Transportation Master Plan, completed in 2015.
- The City also identified the opportunity to possibly incorporate improvements to the access/egress of the P-Patch subdivision.
- Upon completion of the EA process, the City will have a preferred design which can be implemented as required and when funding is available.

OPPORTUNITY STATEMENT

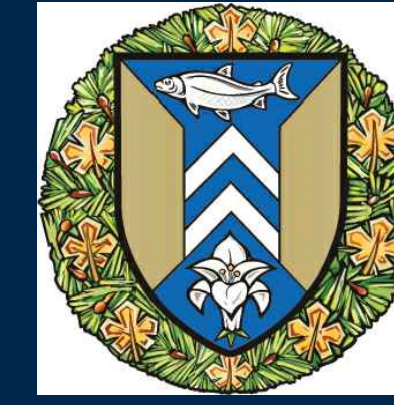

City of
Sault Ste. Marie

Vehicular travel patterns throughout Sault Ste. Marie have shifted over the years as a result of development in the north end of the City. Improving the efficiency of the Northern Avenue corridor is one of the recommendations of the recently completed Transportation Master Plan meant to help accommodate this shift. Implementation of Active Transportation modes was also recommended in the Transportation Master Plan.

Potential improvements noted in the Transportation Master Plan include:

- Opportunity A: Lane reassignment or elimination along the Northern Avenue Corridor
- Opportunity B: Extension of Northern Avenue to Black Road

In conjunction with these possible improvements, the City has also identified:

- Opportunity C: Improvements to the access/egress of the P- Patch subdivision

MUNICIPAL CLASS EA PLANNING AND DESIGN PROCESS

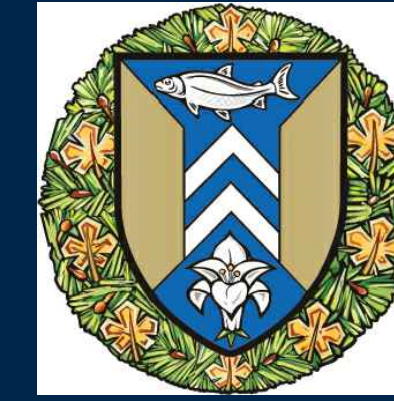

City of Sault Ste. Marie

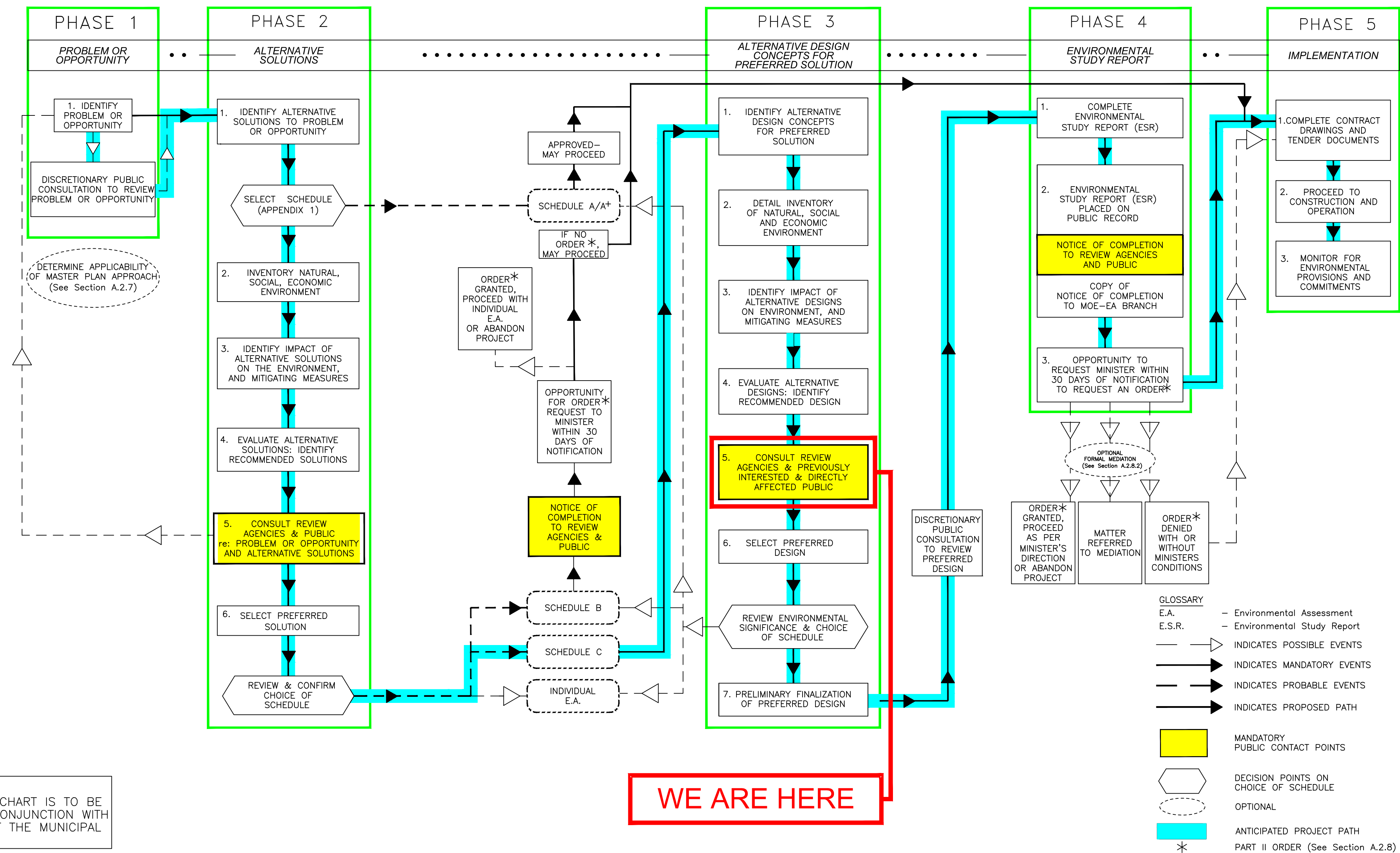

NOTE:
THIS FLOWCHART IS TO BE READ IN CONJUNCTION WITH PART A OF THE MUNICIPAL CLASS EA.



RECOMMENDED DESIGN

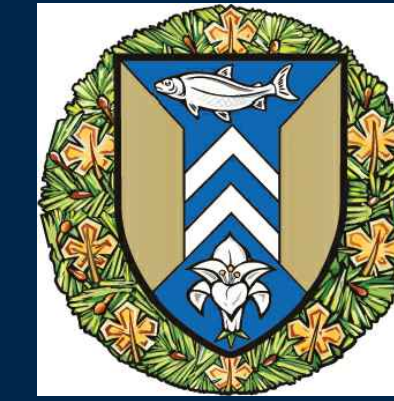

City of
Sault Ste. Marie

Based on the evaluation of the identified Alternative Solutions, the following recommended design is proposed.

- Implement lane reassignment along Northern Avenue between North Street and Pine Street, providing three lanes with a continuous turn lane;
- Designate bike lanes along the north and south sides of Northern Avenue;
- Maintain existing pedestrian sidewalks and boulevards along the corridor; and,
- Construct a new two-lane road from the existing east termination of Northern Avenue south to Princeton Drive to improve access/egress to the P-Patch subdivision.

P-PATCH ACCESS

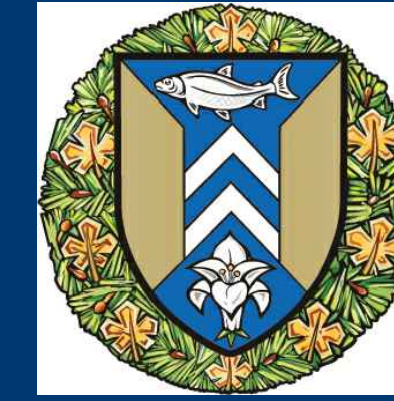

City of
Sault Ste. Marie

CIMA Canada Inc. completed a traffic assessment to further evaluate the identified proposed solutions from a traffic engineering perspective. The following conclusions were noted:

- Under the "do-nothing" option, the Pine Street/Pleasant and Northern Avenue/Pine Street intersections operate with acceptable volume to capacity ratios and levels of service for all approaches;
- The construction of a new access/egress from the east termination of Northern Avenue to Princeton Drive is expected to reduce the average delay for westbound traffic making left-turns at Pine Street and Pleasant Drive; and,
- A neutral impact on traffic operations at the Pine Street/Northern Avenue intersection is anticipated following the addition of a new road between the east termination of Northern Avenue and Princeton Drive.

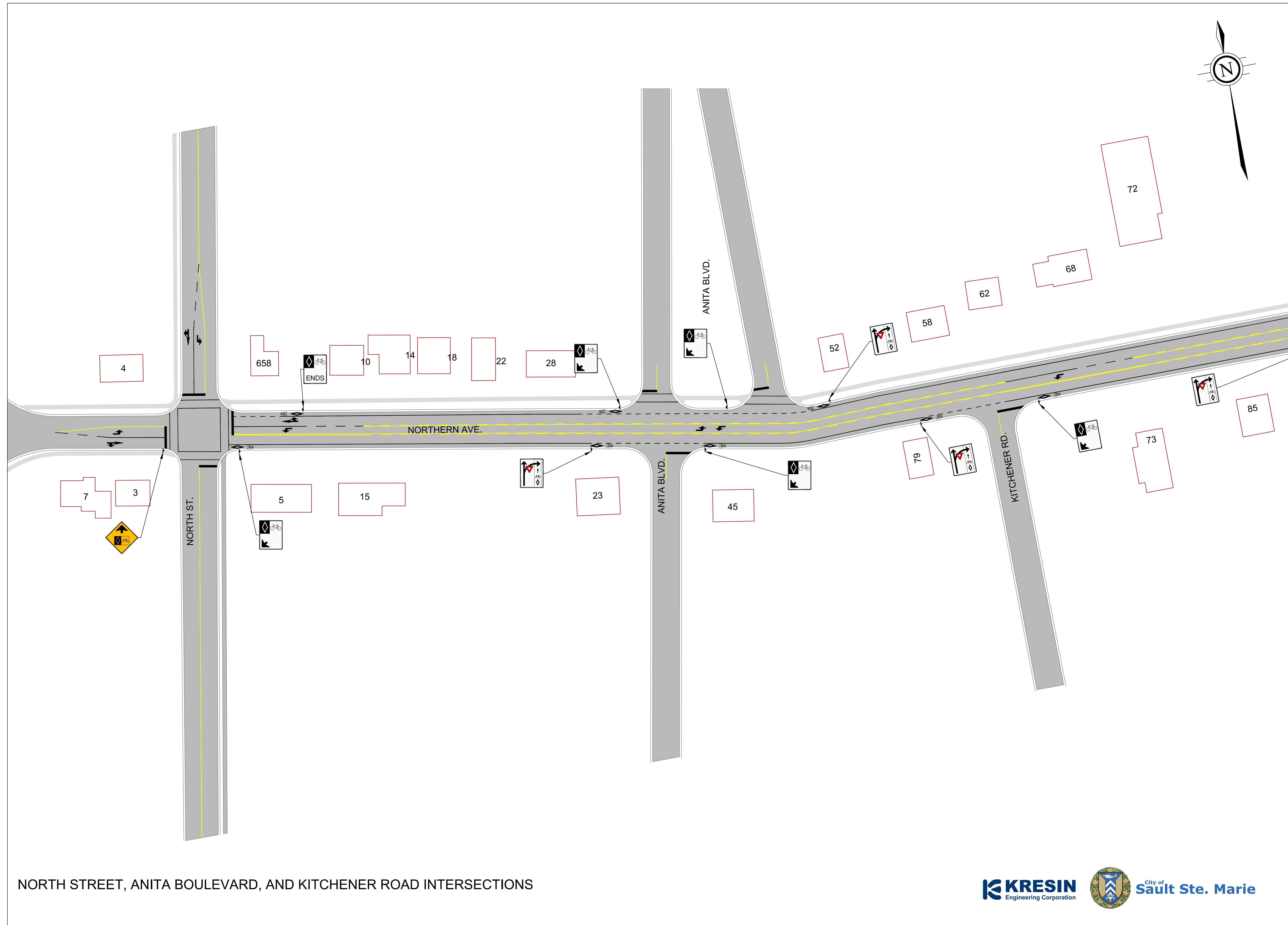
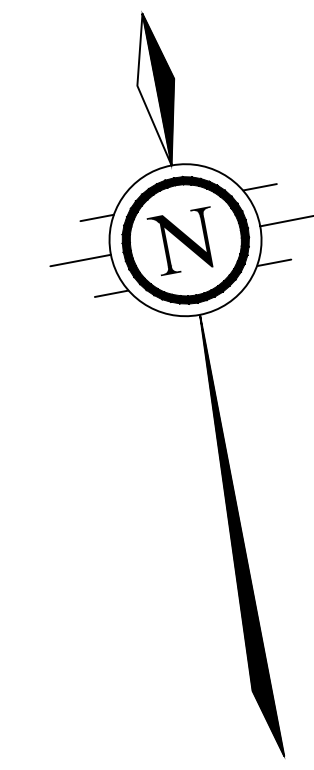

NORTH STREET, ANITA BOULEVARD, AND KITCHENER ROAD INTERSECTIONS

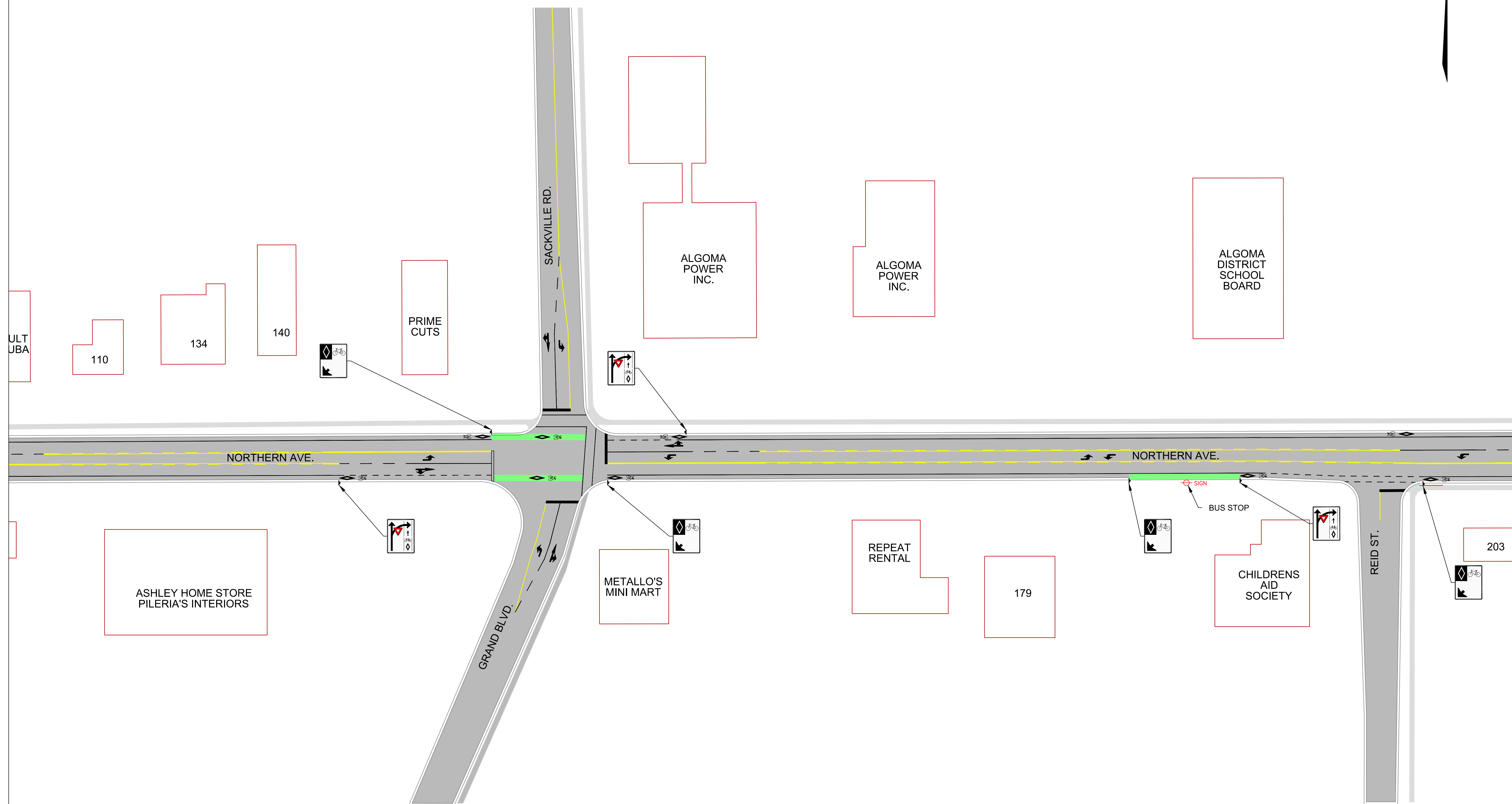
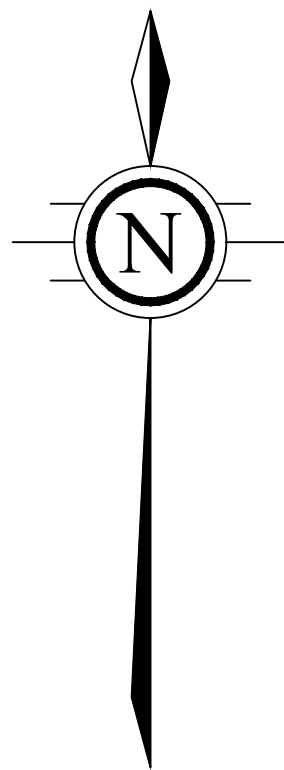

SACKVILLE ROAD, GRAND BOULEVARD AND REID STREET INTERSECTIONS

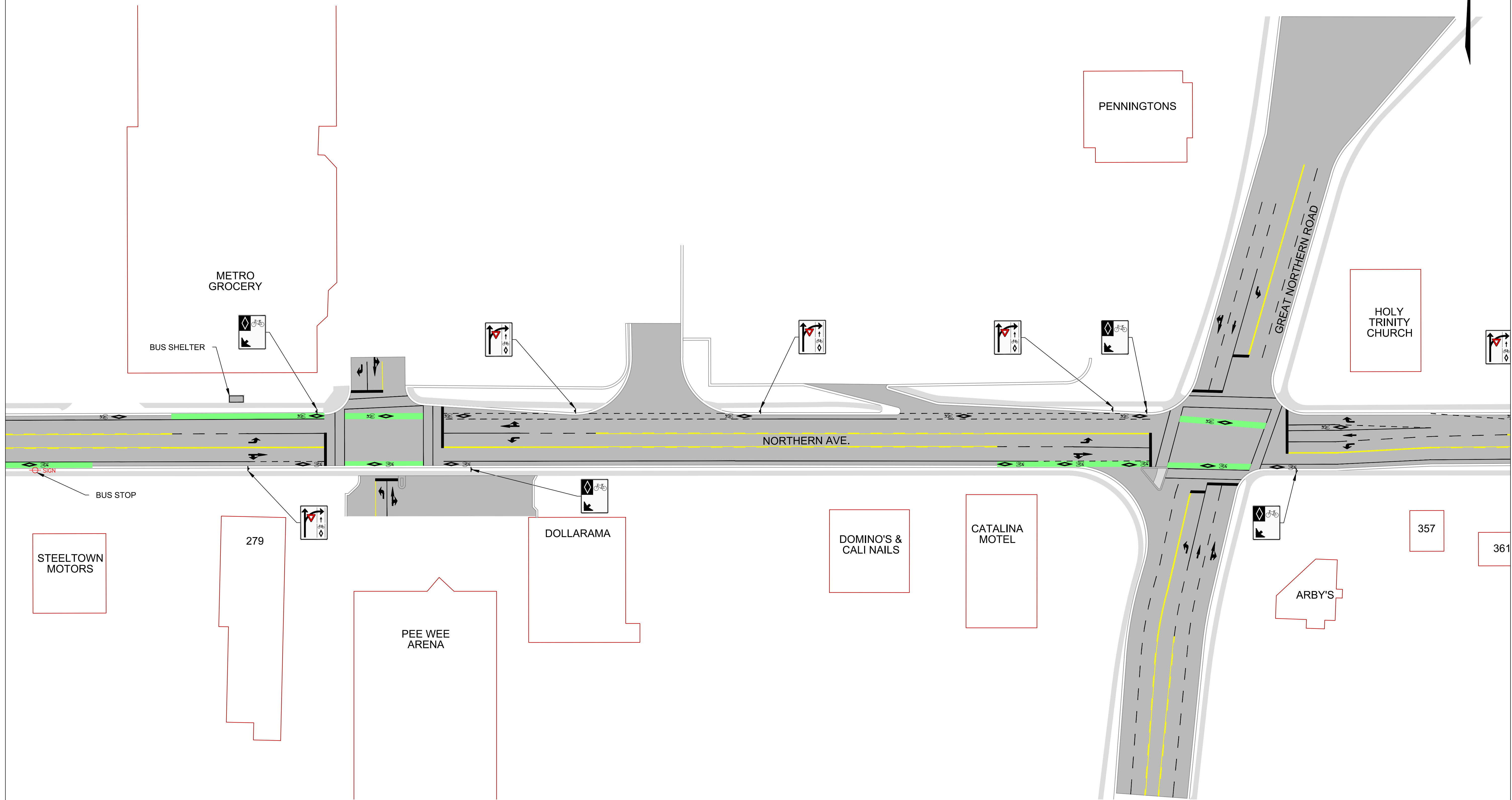
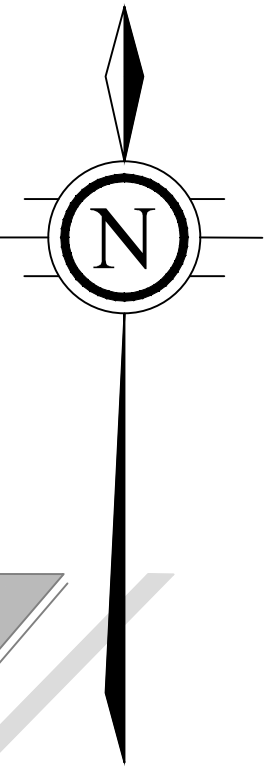

GREAT NORTHERN ROAD INTERSECTION

TADCAS

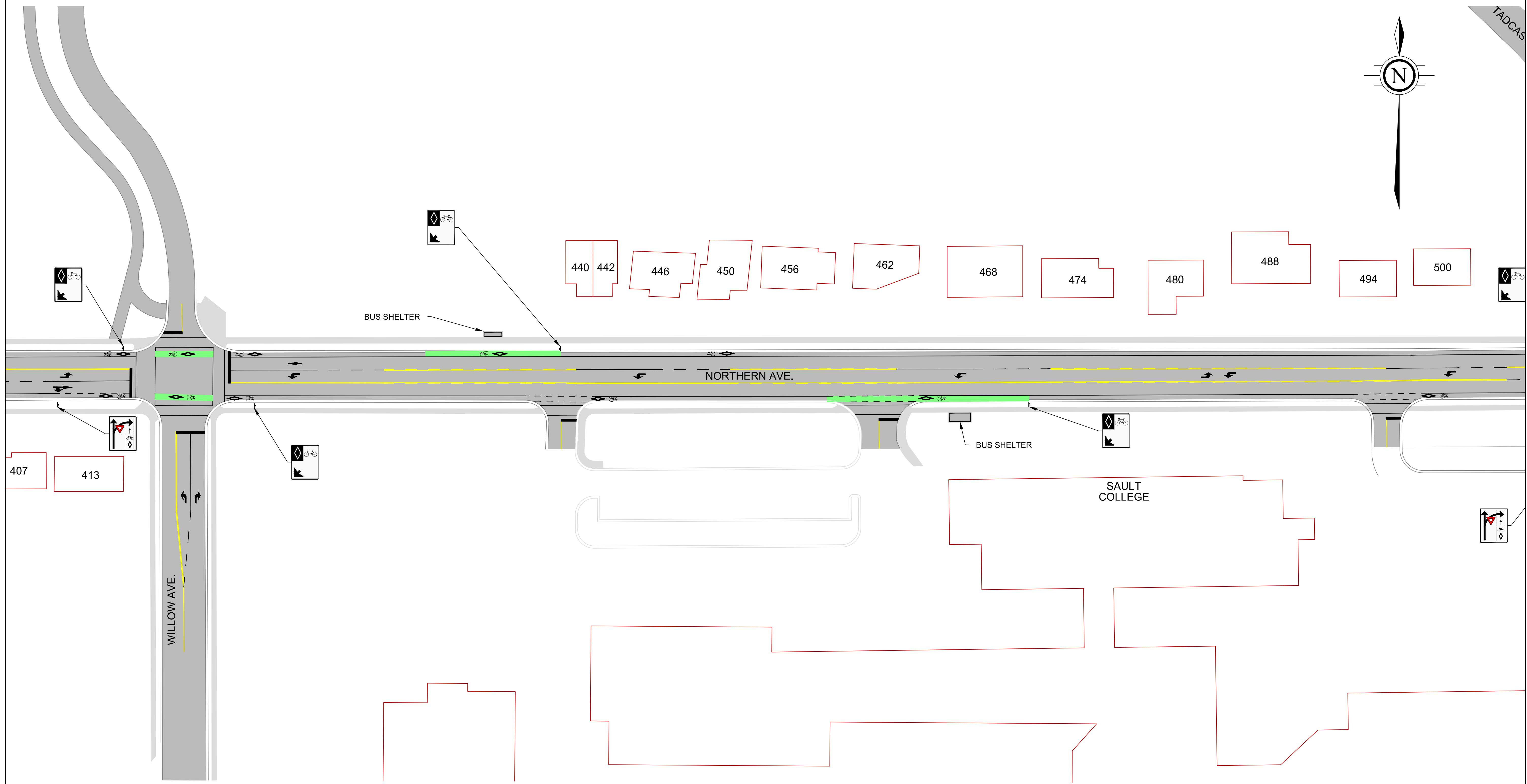
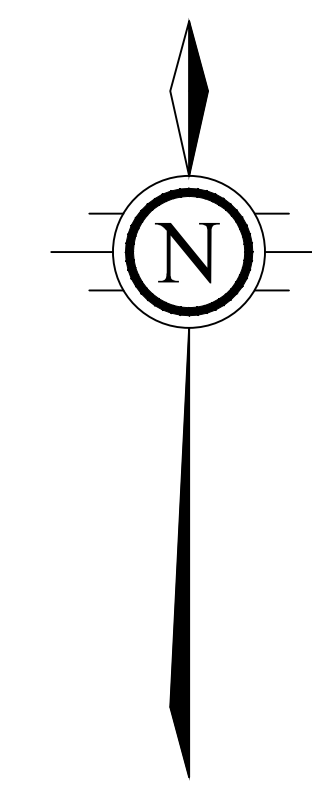

SAULT COLLEGE AND WILLOW AVENUE INTERSECTIONS

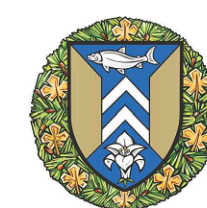

City of Sault Ste. Marie

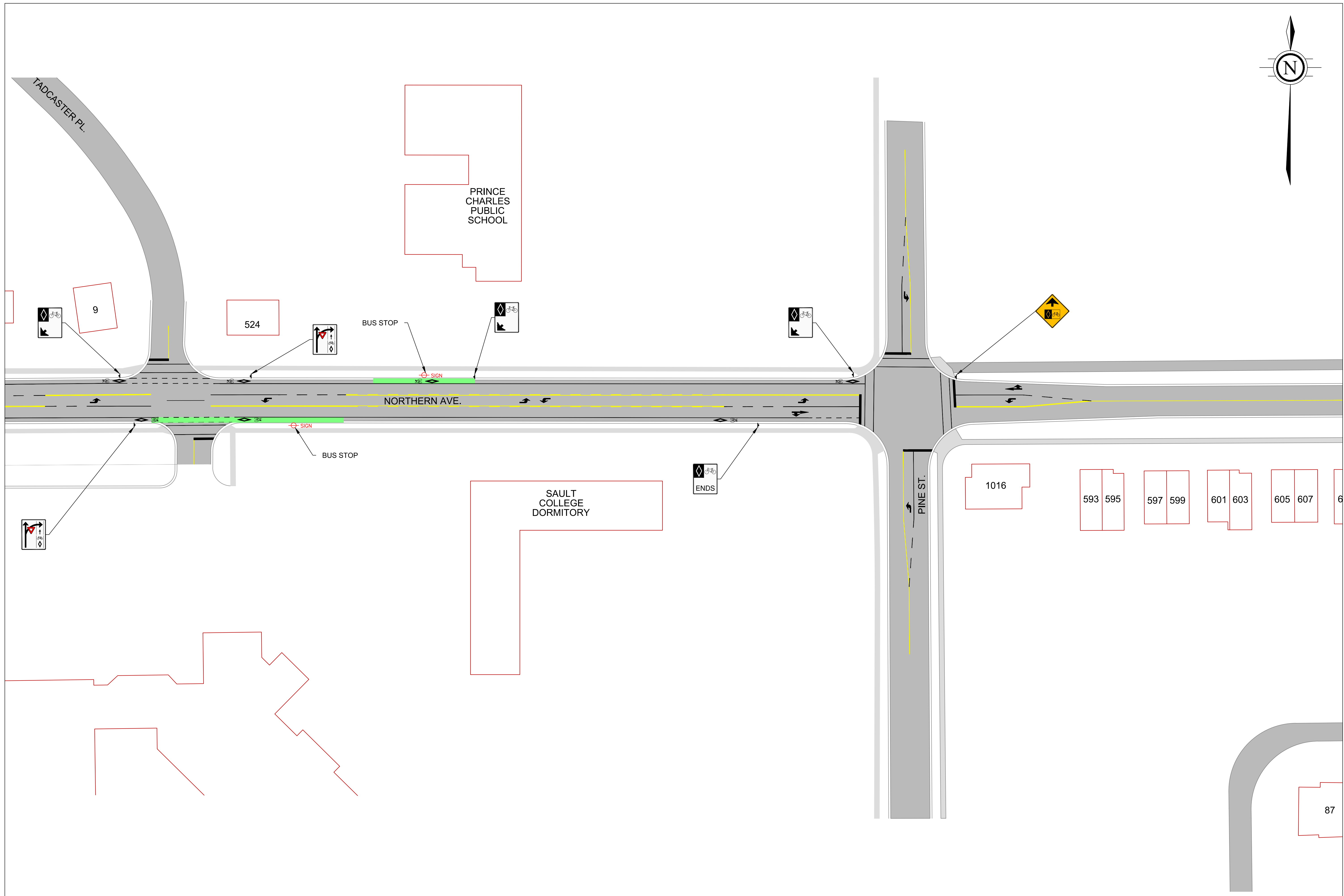
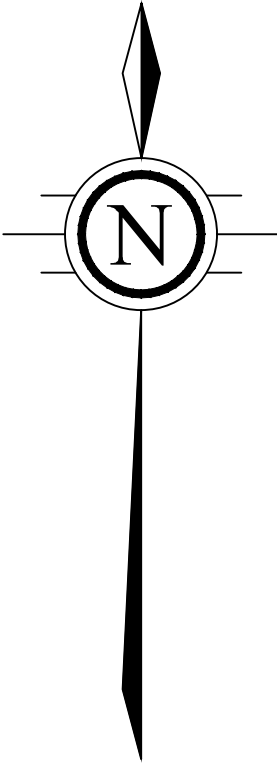

TADCASTER PLACE AND PINE STREET INTERSECTIONS

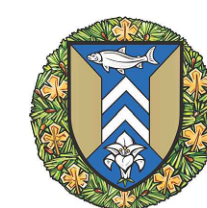

City of Sault Ste. Marie

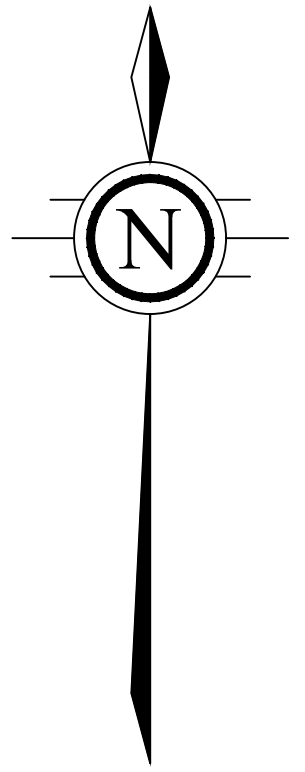

NORTHERN AVE.

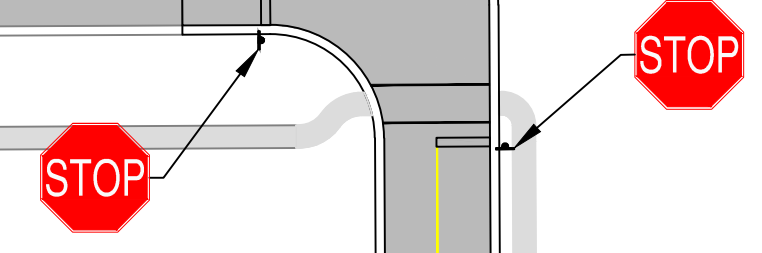

615 617 621 623 625 627 631 633 635 637 641 643 645 647 651 653 655 657

93 95 99 101 103 105 109 111 113 115 117 119 123 125 127 129 133 135



PANORAMIC DR.

94 96 100 102 104 106 112 114 116 118 120 122 124 126 128 130 134 136



14 16 18 20 24 26 28 30 34 36 38 40 44 46 48 50 54 56



PRINCETON DR.

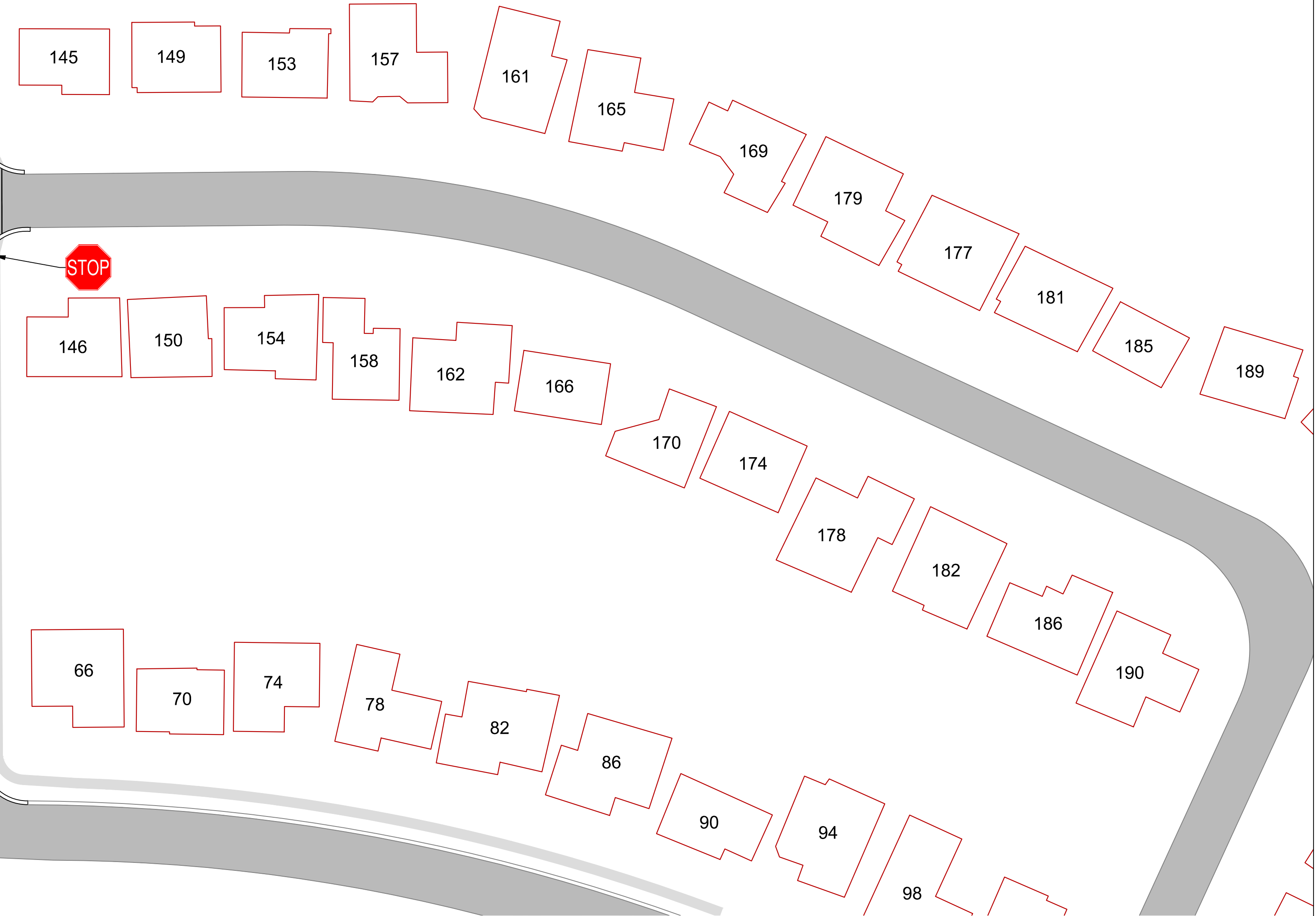

P-PATCH ACCESS - NEW ROAD

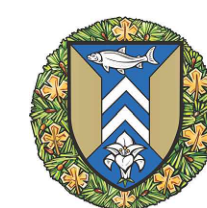

City of Sault Ste. Marie